

# Studio 95 @ The Old Brewery: E1

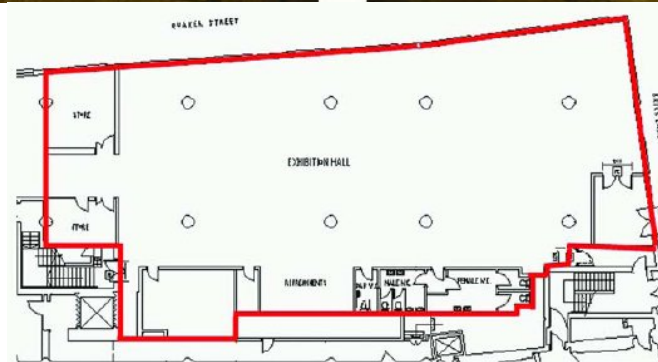

## Main Description:

This dual aspect space sits between Brick Lane and Quaker Street: 6,300 sq ft of self contained studio like open space with hard wood flooring and white painted walls.

In addition to the main space there are 3 ancillary rooms, ample toilets, kitchenette facilities and lobbied frontage onto Brick Lane affording excellent footfall.

A truly unique space ideal for filming, exhibitions, small trade shows, exhibitions and retail opportunities.

## Capacities:

	Capacity	Size
Studio 95	250	6,300 sq ft

for further information, to check the diary and to arrange your viewing please contact

[londonvenuecollection.co.uk](http://londonvenuecollection.co.uk)

0870 383 4595